

abbotFox



Norwich, NR3

Guide Price £220,000 - £230,000

“

We are a team of genuine individuals who hold a deep passion for both property and marketing. Collectively, we bring over 70 years of experience in the property market of Norfolk and Suffolk. Our affection for both counties runs deep, and we are enthusiastic about sharing our passion with you.

Colin McKenzie | **Branch Partner**







THE DETAIL _____

abbotFox presents this newly renovated two bedroom, two bathroom midterrace home, located on Bell Road in the popular NR3 area. The property has been updated throughout and is offered to the market with no onward chain.

The ground floor accommodation comprises a bright and spacious lounge, separate dining room, kitchen and shower room. Upstairs, there are two well proportioned double bedrooms. The main bedroom benefits from its own en-suite shower room. Externally, the property offers a low maintenance rear garden, providing a practical outdoor space with minimal upkeep required.

The property is well positioned within easy reach of Norwich city centre, with a range of local shops, supermarkets, and amenities nearby. There are also good transport links in and out of the city.

An internal viewing comes highly recommended to appreciate this home.







THE HIGHLIGHTS _____

- Popular NR3 location
- Low maintenance rear garden
- Easy access to Norwich City centre
- Close to local shops and amenities
- Good transport links nearby
- Ideal first-time buy or investment property
- Two bathrooms (including en-suite to main bedroom)
- Modern kitchen with space for appliances
- Bright and neutral décor
- Viewing advised

GROUND FLOOR

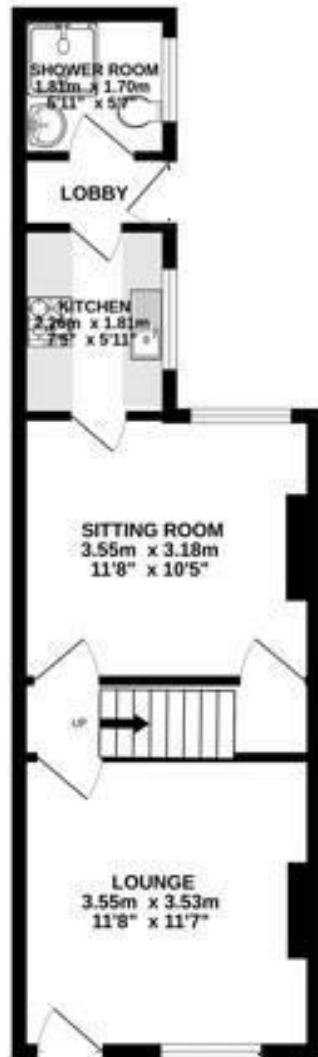

1ST FLOOR



Let's talk

01603 660000

sales@abbotfox.co.uk

@abbotfox

EPC RATING -

Disclaimer – In accordance with the Property Misdescriptions Act, the company abbotFox gives notice that all descriptions, references to condition, necessary permissions for use and other details are given in good faith and believed to be correct, but any purchaser should not rely on them as statements of fact, and must satisfy themselves by inspection or other means, as to their accuracy.